



BEAVER
Homes & Cottages



SECONDARY SUITE COLLECTION

HOME'S EXCLUSIVE MATERIAL PACKAGE GUARANTEE

At Home Building Centre and Home Hardware Building Centre, we want you to be successful in your home or cottage building project. Success means building on time and within budget. That's why we back up all of our packages with this exclusive guarantee.

Design: Whether you select a standard model or have our Architectural Solutions Group modify a model to your specifications, the finished design will meet the requirements of the National and Provincial Building Codes.

Price: The price of the Premium Material Package as originally described in the agreement to purchase with Home Hardware, will not increase from the beginning of the project through completion, in normal construction time.

Quantity: Your Beaver Material Package, as described in the Beaver Homes & Cottages Package Specifications, shall be sufficient to complete construction accordance with the National and Provincial Building Codes and the construction drawings supplied with your Beaver Material Package.

Quality: The standards of building components and other materials supplied by Home Hardware at the time of purchase conform to, or exceed, the National Building Code of Canada, as well as Provincial Codes. All manufactured products are covered by specific Manufacturer Warranties. The workmanship of all building products and components supplied by Home Hardware are guaranteed to be of a standard acceptable to good building practice.

To see a full list of What's Included and our material specifications, scan here



TABLE OF CONTENTS

MODEL	PAGE	SIZE
Hummingbird	4	352 sq. ft.
Merlin	5	400 sq. ft.
Bluebird	6	528 sq. ft.
Robin	7	533 sq. ft.
Blue Jay	8	540 sq. ft.
Oriole	9	572 sq. ft.
Gannet	10	432 sq. ft.
Sandpiper	11	617 sq. ft.
Cardinal	12	624 sq. ft.
Chickadee	13	676 sq. ft.
Loon	14	685 sq. ft.
Mourning Dove	15	700 sq. ft.
Goldfinch	16	728 sq. ft.
Mockingbird	17	731 sq. ft.
Mallard	18	789 sq. ft.
Heron	19	912 sq. ft.
Puffin	20	945 sq. ft.
Partridge	21	314 sq. ft.
Starling	22	816 sq. ft.
Nuthatch	23	1048 sq. ft.
Pelican	24	1094 sq. ft.
Sparrow	25	1180 sq. ft.
Osprey	26	1260 sq. ft.
Kingfisher	27	1354 sq. ft.
Meadowlark	28	1443 sq. ft.
Peregrine	29	1478 sq. ft.
Quail	30	144 sq. ft. & 320 sq. ft.
Warbler	31	144 sq. ft. & 320 sq. ft.
Tanager	32	144 sq. ft. & 320 sq. ft.
Wren	33	144 sq. ft. & 320 sq. ft.

MAKE THE MOST OF THE SPACE YOU ALREADY OWN

Secondary suites offer an innovative solution to expand living space and serve as an excellent option for affordable housing. Beaver Homes & Cottages presents our Secondary Suite Collection, which includes over 30 designs such as Accessory Dwelling Units (ADUs), Bunkies, and Loft Garages. Whether you're aiming to generate additional income, accommodate multigenerational living, or create a backyard retreat, the Secondary Suite Collection has you covered.

To get started, contact your local
Beaver Homes & Cottages Design
Consultant at Home Hardware today.



ADU

HUMMINGBIRD

For more details about
the ADU Collection
scan here.



352 sq. ft.

16'-0" w X 22'-0" d

1 bath

MERLIN



400 sq. ft.

20'-0" w X 20'-0" d

1 bath



ADU

BLUEBIRD



528 sq. ft.

24'-0" w X 28'-0" d

1 bath

ROBIN



533 sq. ft.

32'-0" w X 16'-8" d

1 bath



ADU

BLUE JAY



540 sq. ft.

18'-0" w X 30'-0" d

1 bath

ORIOLE



572 sq. ft.

22'-0" w X 26'-0" d

1 bath



ADU

GANNET



432 sq. ft.

41'-0" w X 16'-0" d

1 bed – 1 bath

ADU

SANDPIPER



617 sq. ft.

25'-0" w X 26'-0" d

1 bed - 1 bath



ADU

CARDINAL



624 sq. ft.

24'-0" w X 28'-0" d

1 bed - 1 bath

CHICKADEE



676 sq. ft.

26'-0" w X 26'-0" d

1 bed - 1 bath



ADU

NOOT



685 sq. ft.

20'-0" w X 41'-0" d

1 bed - 1 bath

MOURNING DOVE



700 sq. ft.

42'-0" w X 16'-8" d

1 bed - 1 bath



ADU

GOLDFINCH



728 sq. ft.

28'-0" w X 30'-0" d

1 bed - 1 bath

MOCKINGBIRD



731 sq. ft.

34'-0" w X 28'-0" d

1 bed - 1 bath



ADU

MALLARD



789 sq. ft.

32'-0" w X 28'-3" d

1 bed - 1 bath

HERON



912 sq. ft.

24'-0" w X 38'-0" d

2 bed – 1 bath



ADU

PUFFIN



945 sq. ft.

37'-6" w X 26'-0" d

2 bed - 1 bath

LOFT
GARAGE

For more details
about the Loft Garage
Collection scan here.



PARTRIDGE



314 sq. ft.
30'-0" w X 28'-0" d
1 bath – 2 car garage

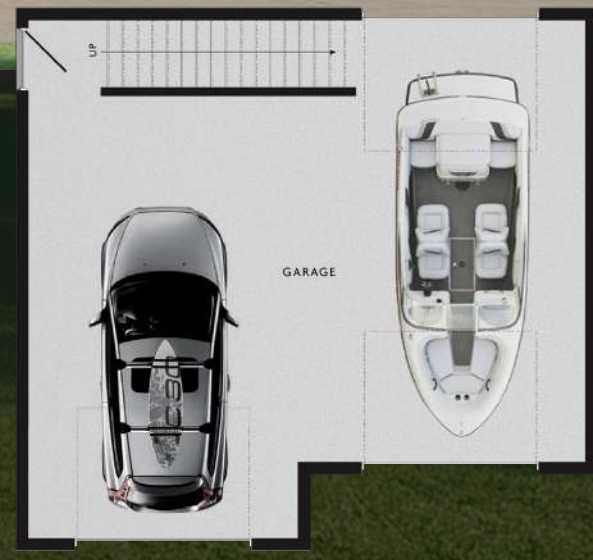

LOFT
GARAGE

STARLING

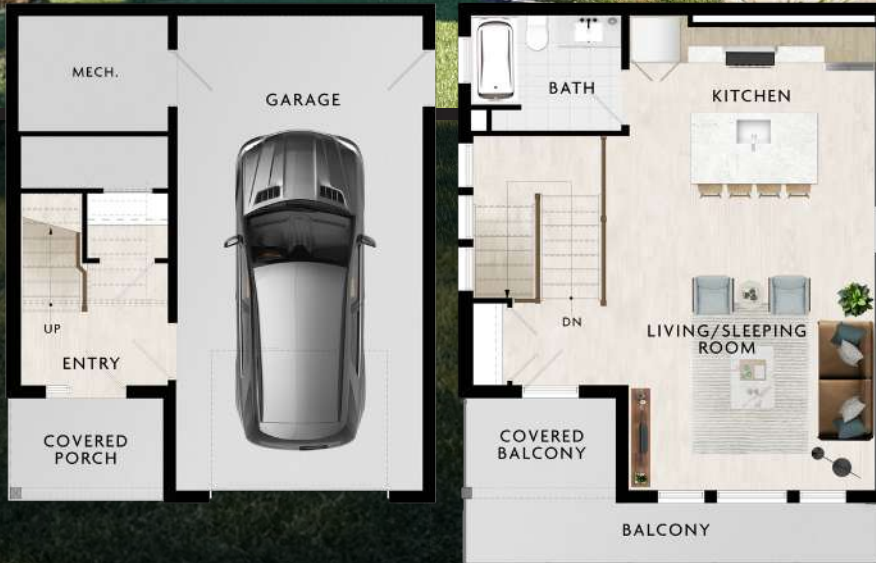

816 sq. ft.

24'-0" w X 28'-0" d

1 bath - 1 car garage



LOFT
GARAGE

NUTHATCH



1048 sq. ft.

37'-0" w X 28'-0" d

1 bed - 1 bath - 2 car garage



LOFT
GARAGE

PELICAN



1094 sq. ft.

26'-0" w X 36'-0" d

1 bed - 1 bath - 1.5 car garage



LOFT
GARAGE

SPARROW



1180 sq. ft.

38'-0" w X 28'-0" d

1 bed - 1 bath - 2 car garage



LOFT
GARAGE

OSPREY



1260 sq. ft.

22'-0" w X 47'-6" d

1 bed - 1 bath - 1 car garage



LOFT
GARAGE

KINGFISHER



1354 sq. ft.

44'-0" w X 38'-0" d

2 bed - 1 bath - 3 car garage



LOFT
GARAGE

MEADOWLARK



1443 sq. ft.

46'-0" w X 40'-6" d

2 bed - 1 bath - 3 car garage



LOFT
GARAGE

PEREGRINE



1478 sq. ft.

52'-0" w X 28'-0" d

2 bed - 1 bath - 3 car garage



BUNKIE



BEDROOM

QUAIL



GYM



LOUNGE



OFFICE

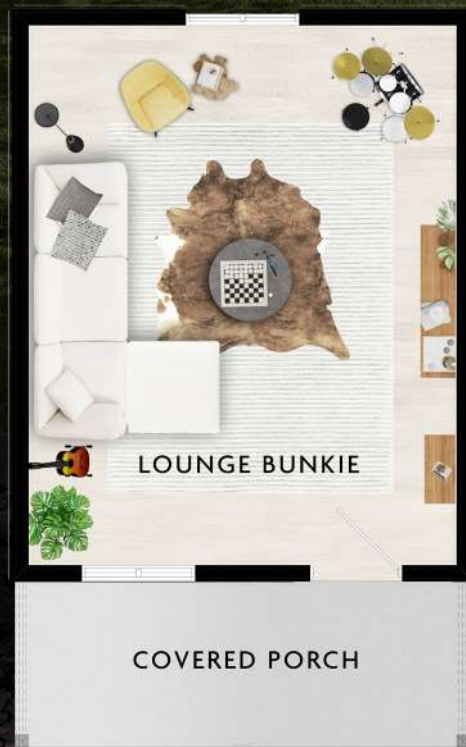

LOUNGE BUNKIE

COVERED PORCH

QUAIL LARGE

320 sq. ft.

16'-0" w X 26'-0" d

ALSO AVAILABLE: QUAIL SMALL
144 sq. ft. | 12'-0" w X 18'-0"



Scan here to see.



WARBLER LARGE

320 sq. ft.

20'-0" w X 16'-0" d

ALSO AVAILABLE: WARBLER SMALL
144 sq. ft. | 12'-0" w X 12'-0"



Scan here to see.



WARBLER

BUNKIE



BEDROOM

TANAGER



GYM



LOUNGE



OFFICE

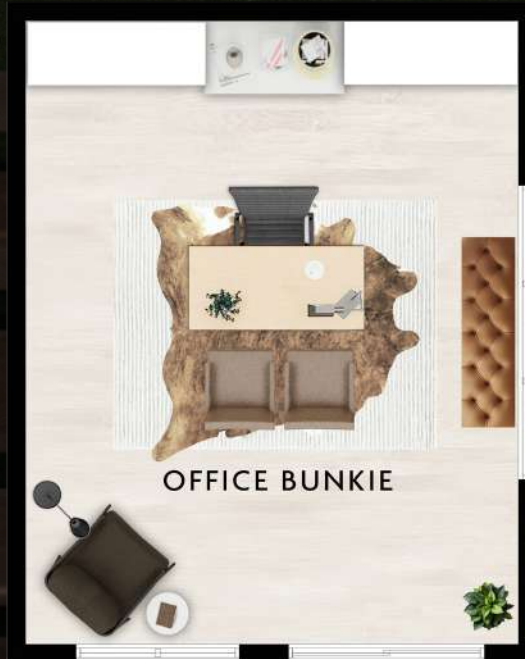

OFFICE BUNKIE

TANAGER LARGE

320 sq. ft.

16'-0" w X 26'-0" d

ALSO AVAILABLE: TANAGER SMALL
144 sq. ft. | 12'-0" w X 12'-0"



Scan here to see.



WREN LARGE

320 sq. ft.

20'-0" w X 16'-0" d

ALSO AVAILABLE: WREN SMALL
144 sq. ft. | 12'-0" w X 12'-0"



Scan here to see.



BUNKIE

BEDROOM



GYM



LOUNGE



OFFICE

WREN

LEGAL

IMPORTANT INFORMATION REGARDING THIS BOOK:

Home Hardware Stores Limited ("Home Hardware") has assembled a collection of homes and cottages covering a wide range of styles, designs and sizes. The models displayed in this book are a combination of new designs and proven classics that continue to be popular. Blueprints for the designs in this book and on BeaverHomesandCottages.ca are not available to purchase, however they are provided as part of a Beaver Homes & Cottages Material Package. Design modifications to suit your wants and needs can be achieved through a Preliminary Drawing Process, and are available at no additional charge to Beaver Homes & Cottages Material Package purchasers. A non-refundable deposit on your Beaver Homes & Cottages Material Package is required to start the preliminary drawing process. Modifications can be minor, such as resizing a window or moving a closet or major changes like adding a loft or increasing the square footage.

WHEN CONSIDERING A DESIGN PLEASE KEEP THE FOLLOWING IN MIND

The renderings in this book are artists' impressions. They show certain finishes such as, but not limited to; decorative treatments, decks, railings, garages, fireplaces, chimneys, skylights, masonry veneer, stone, stucco or other optional items that are intended to help visualize finishing alternatives which may not be included in the material package price. Structural framing material for decorative chimneys where shown is included in the material package price, however, the heating appliance, flue system and accessories are not included in the material package. While every effort is made to ensure the accuracy of these renderings, should there be a discrepancy the working drawings shall govern. Venting for heating systems, gas fireplaces and hot water heaters are assumed to be direct vent. In situations where this is not possible and provisions have not been made in the design, consult with your local Beaver Homes & Cottages Design Consultant to make appropriate changes. All finished exterior wall surfaces are specified to be vinyl siding. Some model images are shown with finishing products that are not included in the material package. A change to an exterior wall finishing product that is different than shown in the model image should be discussed with your Consultant as the standard blueprints with reflect the finishes shown in the book. Foundation plans do not include a ledge to support masonry veneer. If a change to masonry veneer is made, the foundation will need to be adjusted accordingly, thus maintaining the square footage as shown on the plan. For details please refer to the Beaver Homes & Cottages Package Specifications or contact your Beaver Homes & Cottages Design Consultant. Concrete, whether poured-in-place or pre-cast, is not included. Whenever possible, room dimensions are based on the usable size of the room and are taken from the inside framing face of the wall. Where a discrepancy occurs, the working drawings shall govern.

The square footage shown is the finished living area, including all walls. Where applicable, the square footage of garages, unfinished areas or basements are shown separately. Exterior dimensions indicate the longest aggregate dimension for the width and depth of the model.

Home Hardware Building Plans are designed to meet or exceed the Canadian National Building Code and to address Provincial Building Codes in effect at the time the drawings were ordered. Design loads and criteria are clearly stated on our plans, however, local building regulations, bylaws, safety concerns and energy consumption can vary greatly from region to region. Should non-standard building conditions such as high wind or snow loads, inadequate soil bearing conditions, seismic requirements or structural specifications not specifically dealt with in the aforementioned codes exist, building authorities may require an engineer's report. If such a report is required, it is the responsibility of the owner/builder to provide same. Contact your local building official for guidance.

All designs, renderings, floor plans and images in this publication are protected by copyright law. Reproduction by any means of the illustrations or floor plans in whole or part in any format or preparation of derivative works thereof, without prior written permission of Home Hardware is strictly prohibited. Artwork licensing can be obtained through Home Hardware Stores Ltd. See local Dealer for details.

Plans are provided for the sole purpose of construction under license of one and only one dwelling. The purchase of a material supply package including plans in no way transfers copyright or other ownership interest to the buyer. Building more than one licensed dwelling from a set of plans constitutes as copyright infringement. All plans, drawings, blueprints, and construction drawings including Quarter Prints prepared by Home Hardware (collectively "Plans") supplied to the buyer by the Dealer are protected by copyright law and shall not be assigned, reproduced, copied, sold, leased, loaned, given or used in any other manner without written permission from Home Hardware. Only the original buyer has the right to build the licensed structure from the Plans purchased. Trademarks are owned or used under license by Home Hardware.



Finance Your Next Project with **Scotiabank**®

From bunkies to loft garages, Scotiabank can help you find the right financing options. Start your project with a peace of mind knowing your financing is in place – the best time to speak with a Scotiabank Home Financing Advisor is at the start of your home renovation project!

Ready to get started?

- 1 Contact your local Beaver Homes & Cottages Design Consultant for a complimentary pre-construction consultation to determine your renovation needs.
- 2 Next, you'll be connected to a Scotiabank Home Financing Advisor who can provide you with knowledgeable advice and help customize borrowing solutions that meet your needs.



**Scan to find a Beaver Homes & Cottages
Design Consultant near you.**

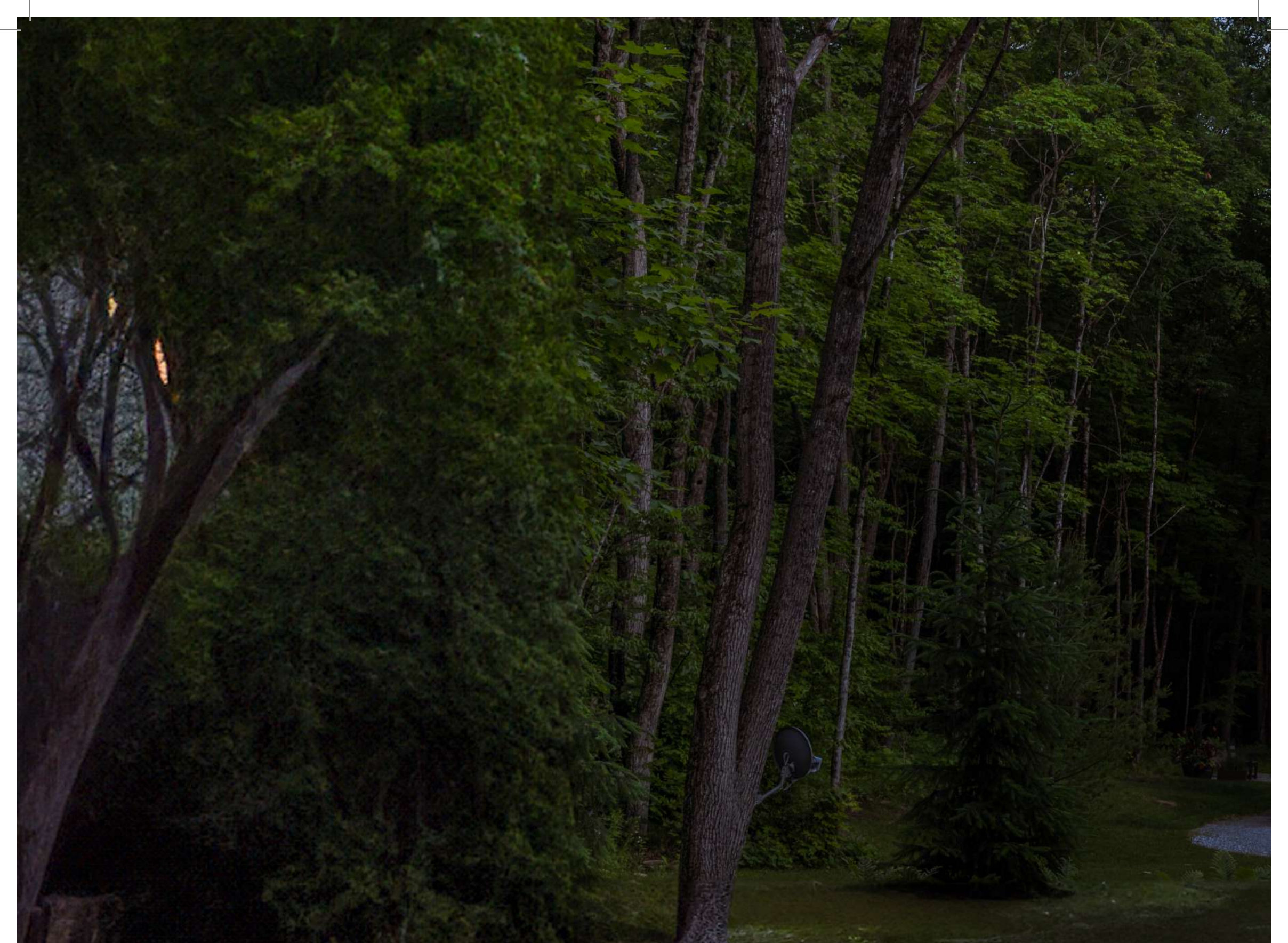

BeaverHomesAndCottages.ca

\$9.99



2656-098